

 Create pdf

## Lampholders and starter holders

26.305.5001

BJB Connector System

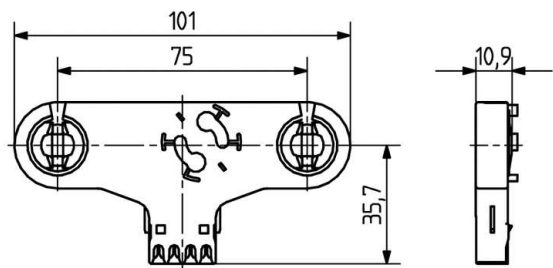

colour	pkg.	wt.	part no.
white	200	18 g	26.305.5001.50

With starter holder

G13 Lampholder for the BJB connector system

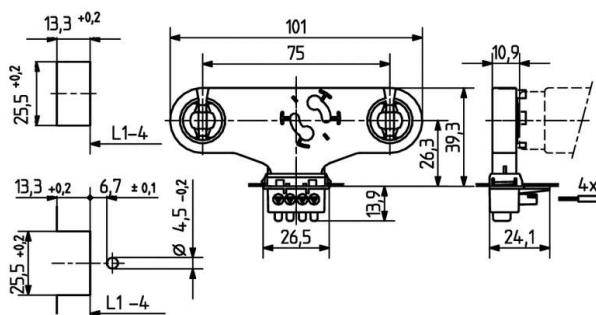

Lamp centre: 26.3 mm  
Push fixingHousing: PC  
Rotor: PBT

- Can only be use with 26.921 adapter
- Contacts: IDC Termination
- A pair of lampholders provides a lamp length tolerance compensation of 3 mm

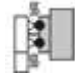

Example of application with adaptor 26.921

L1-4: Recommended dimension - the final distance should be governed by the dimensions of the respective lamps and luminaires.

T 130	Tm 110		 0.5 mm <sup>2</sup>	
-------	--------	---	--	---

Document generated on: Th, 9. February 2017 - 14:49